

DEVORE RURAL PROTECTION ASSOCIATION

February 2024



Devore Water Company Board of Directors

The official results for the Devore Water Company Board of Directors election have been released by Patricia Caskey, the CPA hired by the DWC. The following nine Devore Water Company shareholders have been elected to the 2024-2025 board of directors.

Paul Kirkland-President
Julia Costa-Vice President
Doug Claflin-Secretary/Treasurer
Brian Gilbert
Bill Klapp
Mario Leos
John (Mike) Thompson
Steve Avila



The newly elected water board took office on January 30th, 2024. Thank you to everyone for voting. As a shareholder, your vote is crucial. The initial priority was to gain a deeper understanding of the company's current activity and financial status. As our water company transitions, our board members remain committed to completing the outstanding projects to ensure a structurally sound water company for our community. We look forward to opening the doors to our community and providing answers to their questions. Our local water company is a pillar in our community. We have work to do and the support of the community plays a vital role.



Respectfully,
The Devore Water Board



Doug, Paul, Julie



Congratulations

Welcome to the new DRPA members

Sarah Phelps , Lori Campbell, Michelle Kirkland, Josh Costa



Oasis at Glen Helen project updates

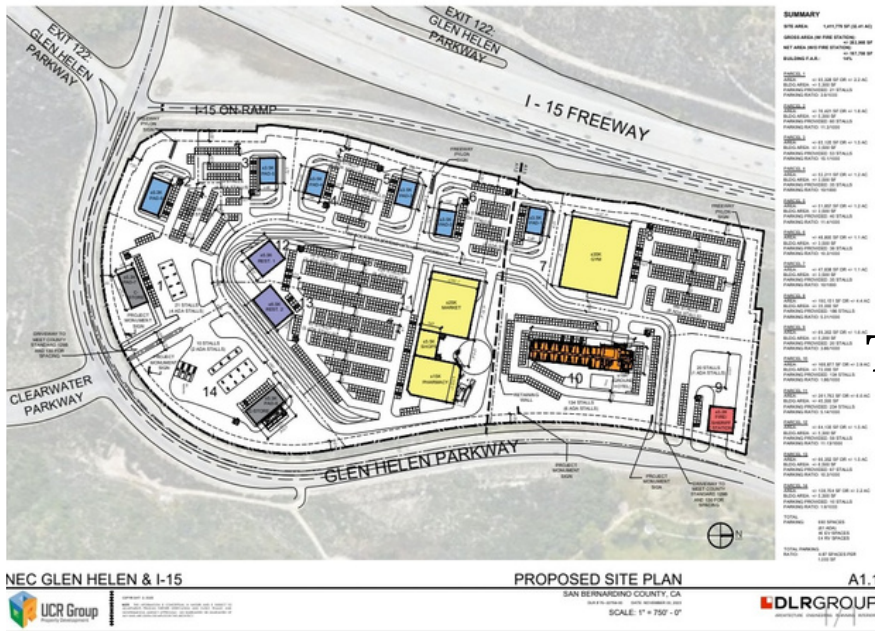

This project is going to include

- Fire/ Sheriff station
- hotel
- market
- rest stop
- shops
- pharmacy
- gym
- and much more



DEVORE RURAL PROTECTION ASSOCIATION

Tentative Tract Update

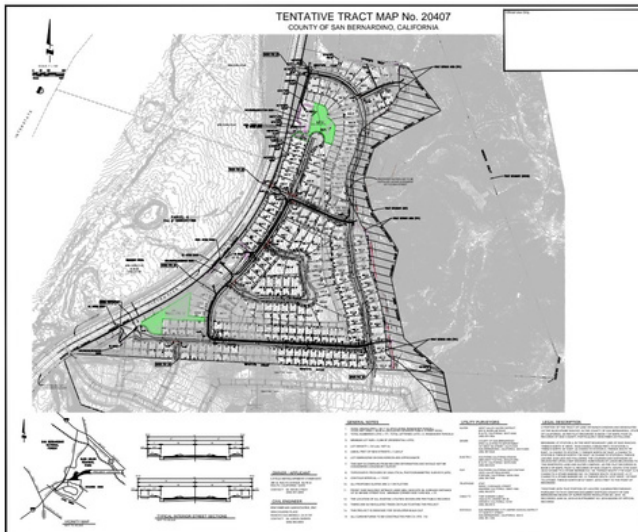

NOTICE OF HEARING

A PUBLIC HEARING HAS BEEN SCHEDULED BEFORE THE SAN BERNARDINO COUNTY PLANNING COMMISSION TO CONSIDER THE FOLLOWING APPLICATION:

NOTICE IS HEREBY GIVEN that the Planning Commission of the County of San Bernardino, at its regular meeting on **Thursday, February 22, 2024**, will conduct a public hearing to consider:

Proposal: A TENTATIVE TRACT MAP (NO. 20407) REQUEST TO SUBDIVIDE TWO LOTS (TOTAL 132.16 ACRES) INTO 171 LETTERS LOTS AND 6 REMAINDER PARCELS FOR THE DEVELOPMENT OF 171 SINGLE FAMILY HOMES ON LOTS SIZES RANGING FROM 5,000 SQUARE FEET TO 7,000 SQUARE FEET, ON A TOTAL OF 93.17 ACRES, LOCATED NORTH OF ROSENA RANCH ALONG CLEARWATER PARKWAY IN THE GLEN HELEN SPECIFIC PLAN, SINGLE FAMILY RESIDENTIAL - SYCAMORE FLATS (GHSP-SFR-SF) ZONING DISTRICT AND SPECIAL DEVELOPMENT LAND USE CATEGORY.

Project #PROJ-2021-00148. Date filed: 11/03/2021.

Applicant: Lytle Development

Environmental Determination: A finding of exemption will be considered for compliance with the California Environmental Quality Act.

Time and Place of Hearing: 9:00 a.m. or thereafter, in the Chamber of the Board of Supervisors, County Government Center, 385 North Arrowhead Avenue, First Floor, San Bernardino, CA.

Hearing Participation: Any person affected by this application may submit their concerns in writing prior to the hearing or appear in person and be heard in support of or in opposition to the proposal at the time of the hearing.

If you challenge any decision regarding the above proposal in court, you may be limited to raising only those issues you or someone else raised at the public hearing described in this notice or in written correspondence delivered to the Planning Commission at, or prior to, the public hearing. Due to time constraints and the number of persons wishing to give oral testimony, time restrictions may be placed on oral testimony at the public hearing regarding this proposal. You may wish to make your comments in writing to assure that you are able to express yourself adequately.

The proposed project application and environmental finding may be viewed at the Planning Division at: 385 N. Arrowhead Avenue, San Bernardino, CA 92415-0187 from 8:00 a.m. until 4:30 p.m., Monday thru Friday. To assure that someone will be available to assist you, staff requests that you call the Planning Division at (909) 387-8311 to set a time to review the documents. NOTE: The Planning Commission in its deliberation could approve an alternative proposal for the above Project.

Planning Commission of the County of San Bernardino

The proposed project will have 93 acres with 171 new single-family homes.



Brightline is the only private provider of modern, eco-friendly, intercity passenger rail service in America. Recognized by Fast Company as one of the Most Innovative Companies in travel, Brightline offers a guest-first experience designed to reinvent train travel and take cars off the road by connecting city pairs and congested corridors that are too short to fly and too long to drive. Brightline is currently operating its first passenger rail system in Florida connecting Central and South Florida with stations in Miami, Aventura, Fort Lauderdale, Boca Raton, West Palm Beach and Orlando.

Brightline West will build on Florida's award-winning service by connecting Las Vegas and Southern California with the first true high-speed passenger rail system in the nation. This 218-mile, all-electric high-speed rail service will include a flagship station in Las Vegas, with additional stations in Apple Valley, Hesperia, and Rancho Cucamonga. At speeds up to 200 miles per hour, trains will take passengers from Las Vegas to Rancho Cucamonga in just 2 hours and 10 minutes, twice as fast as the normal drive time. The Rancho Cucamonga Station will connect to Southern California's regional Metrolink service, allowing for seamless connectivity into downtown Los Angeles and beyond.

Join Us in Creating a Fire-Wise Community for a Safer Future!

Dear Community Member,

We hope this letter finds you in good health and high spirits. As part of the Firewise USA Devore community, we are excited to reach out and invite you to become an integral part of our efforts in promoting fire safety and prevention through the Fire-Wise Program.

The Fire-Wise Program is a community-driven initiative aimed at taking proactive measures to mitigate the risk of fire outbreaks, protect our beloved surroundings, and ensure the safety and well-being of all community members. By actively engaging in this program, we can work together to develop a fire-wise community and create a brighter and safer future for everyone

Joining the Fire-Wise Program means participating in various community involvement activities that provide invaluable

benefits to you, your neighbors, and the environment. Here are some of the ways you can contribute:

- 1. Education and Awareness:** Gain knowledge about fire prevention techniques, evacuation plans, and safety measures through informative workshops and training sessions. Share your understanding of fire safety with fellow community members, empowering them to protect themselves and their properties.
- 2. Community Cleanups:** Participate in regular clean-up events to clear potential fire hazards, such as dry leaves and brush, from neighborhoods and public spaces. By working together to maintain a clean environment, we can significantly reduce fire risks.
- 3. Fuel Reduction Projects:** Collaborate with our team to implement fuel reduction projects, like clearing dead vegetation or strategically thinning trees, which help create a fire-resistant landscape. Be part of the solution to minimize the impact of wildfires on our community.
- 4. Neighborhood Preparedness:** Engage in neighborhood drills and emergency response exercises to ensure that everyone is prepared and ready to respond effectively in case of a fire outbreak. By practicing emergency protocols together, we can minimize panic and enhance community resilience.
- 5. Volunteer Opportunities:** Contribute your time, skills, and expertise by volunteering with the Fire-Wise Program. Whether it's organizing events, conducting surveys, or assisting with administrative tasks, your involvement will play a crucial role in building a resilient community. By participating in the Fire-Wise Program, you will not only be actively protecting your own property but also contributing to the well-being and safety of the entire community.

Your involvement and dedication can make a profound impact on reducing the risk of wildfires and ensuring the sustainability of our beautiful surroundings. We encourage you to join us in this noble cause and embark on this journey together. Let us unite as a community to create a fire-wise environment where everyone can live, work, and thrive without fear.

To get involved or learn more about the Fire-Wise Program, please contact us at Castawaykat@aol.com. Together, we can create a safer, more resilient community that future generations will be proud of. Thank you for considering our invitation, and we look forward to working with you to make a difference.

Warm regards,
Nanette Van Esch
Firewise USA Devore Community



DEVORE RURAL PROTECTION ASSOCIATION

TRAFFIC AND SAFETY CONTROL



Traffic safety is of utmost importance for residents and schools to ensure the well-being and protection of individuals, especially children. Here are some key measures and guidelines to enhance traffic safety:

- **Speed limits:** Establish and enforce appropriate speed limits in residential areas and school zones. Lower speed limits provide pedestrians and drivers with more reaction time and reduce the severity of accidents.
- **Traffic signs and signals:** Install clear and visible signage, including stop signs, pedestrian crossings, speed limit signs, and traffic lights. These indicators help regulate traffic flow and increase awareness among road users.
- **Crosswalks and pedestrian facilities:** Ensure the presence of marked crosswalks and designated areas for pedestrians, especially near schools. Implement traffic-calming measures such as speed bumps, raised crosswalks, or refuge islands to facilitate safe crossing.
- **School zone safety:** Designate school zones with reduced speed limits during specific times, such as morning drop-offs and afternoon pick-ups. Prominently display signs indicating the presence of a school zone to alert drivers to exercise caution.
- **Traffic education:** Conduct educational programs to raise awareness among residents, students, and parents about traffic safety rules, such as the importance of using designated crosswalks, wearing reflective clothing, and avoiding distractions while driving or walking.
- **School bus safety:** Develop and enforce regulations for safe school bus operations, including regular maintenance of buses, proper driver training, and loading/unloading procedures that prioritize student safety.
- **Parental involvement:** Encourage parents to actively participate in promoting traffic safety by organizing neighborhood watch programs, volunteering as crossing guards, or coordinating walking school buses to ensure students' safe commute.
- **Infrastructure improvements:** Work with local authorities to identify areas that require traffic safety enhancements, such as improved road signage, additional street lighting, and better-designed intersections to minimize risks.
- **Enforcement and monitoring:** Collaborate with law enforcement agencies to enforce traffic rules and regulations, particularly in school zones. Regular monitoring and ticketing of speeding or reckless drivers can act as a deterrent and improve compliance.

This is the QR code to Google Maps. This QR Code will help the residents report these issues. We want to eliminate Devore from being the "alternate route".



This QR Code will allow residents to submit complaints/requests for Caltrans to do maintenance on roads (ex. encampments, litter, graffiti, illegal dumping, and road improvements, etc)



The California Department of Transportation (Caltrans) owns or controls 350,000 acres of Right of Way and maintains 15,133 centerline miles of highway and 13,063 state highway bridges. Caltrans also inspects more than 12,200 local bridges.



SEE PHOTOS OF YOUR MAIL BEFORE IT ARRIVES, START YOUR MORNINGS WITH A PREVIEW OF YOUR DAY'S USPS® MAIL AND PACKAGES WITH INFORMED DELIVERY®

NOTIFICATIONS: GET DAILY DIGEST EMAILS THAT PREVIEW YOUR MAIL AND PACKAGES SCHEDULED TO ARRIVE SOON. SEE IMAGES OF YOUR INCOMING LETTER-SIZED MAIL (GRAYSCALE, ADDRESS SIDE ONLY). 1 TRACK AND MANAGE YOUR PACKAGES IN ONE CONVENIENT PLACE.

Saddle Up[®] for St. Jude

What is Saddle Up for St. Jude?

Saddle Up[®] for St. Jude is a fun, family-oriented fundraising event based around horseback riding that supports St. Jude Children's Research Hospital.[®] Typically, Saddle Up for St. Jude events consist of trail rides, horse shows and other equestrian events. Horse enthusiasts and the general public alike have joined together to hold *Saddle Up for St. Jude* events across the country to help in the hospital's fight against childhood cancer and other catastrophic diseases.

How does it work?

Saddle Up for St. Jude coordinators recruit participants and provide them with fundraising materials. Participants contact family and friends to obtain sponsorships for taking part in the ride. Donors can make pledges based on the total miles completed during the ride or make a flat donation. After sponsors are obtained, participants come together to take part in the *Saddle Up for St. Jude* event.



St. Jude patient Reese with her mom Marilyn

Why should you do it?

- Provide help for St. Jude patients battling cancer and other deadly childhood diseases.
- Provide a meaningful event to bring your community together.
- Earn great prizes. Visit stjude.org/saddleup for a complete list.
- Resources ensure you have a successful event, including an easy-to-use website that allows you to create customized web pages and much more.

Contact Karan Slobom for info (909) 278-9896

Saturday, May 18th Location: SB Sheriff Rodeo Grounds Time:9am

Horse Obstacle Challenge, Trial Ride, Raffle, Food, Pony Ride, Petting Zoo, & more.



THE FLOOD OF 1938

The flood of 1938 and the following few years were long remembered in San Bernardino. They resulted in a concerted effort by county engineers to create dams, flood plains, etc., to keep control of the water that overflowed the streams and rivers which ran off the San Bernardino Mountains. This helped control the damage created in earlier days. Even so, I know George was very concerned when he heard a man was going to build a house in the wash across Main Street, just below our house. He talked with the man and explained that the Kimbark River had overflowed in the flood of 1938. It had run down the wash where the man was building and also took out Main Street. The man assured George that the County Engineer told him that the work they had done would prevent that happening again. As it turned out, the neighbor was right. However, George thought the man was foolish to build in a wash. Once the man built his house, he decided to landscape his backyard. He utilized the native rocks to build a stream with ponds and waterfalls. Then he went above and diverted some of the water from the Big Kimbark River by digging a trench through its high banks. This created a lovely stream and enhanced his landscaping. George said the man was crazy to fool with Devore's river. When the next big rain arrived, George was proven right. The Big Kimbark River roared down the mountainside, and when it found the man's diversion duct, it dug it even deeper and ran down the wash. It ruined the man's lovely stream and landscaping. It also washed out the picnic area the Civic Association had worked so hard to create in Gladwill's corner at Main and Kenwood Streets. It doesn't pay to fool with Devore's rivers and streams!



Right—Kimbark Lake, i.e. the playground at Kimbark School during the 2003 flood, which immersed the equipment like the monkey bars at least half way. Photo by a Kimbark teacher from the Kimbark files.



Below—Cable Canyon on Christmas Day, 2003 and two days later. Photos from Scott Ring



Above left—Phil and Gwen Lamson enjoy their front yard.
Below left—The Lamson children play in their creek that winds its way around the foot of a gentle slope in 1937.
Above—Kimbark River, March 3, 1938, the day after the flood, which replaced the creek left with a torrent and took the yard (above left) away.
Photos by Edith Lamson contributed by Gwen Lamson Mulholland.
Looks as if the flood may have been preceded by a fire! This river is flowing where only a gentle creek ran before. Sherman Thomas said many water courses changed in 1938.



MORE ON FLOODS

By Alice Eby Hall

From Echoes of Eden

The biggest flood, in 1938, killed 87 people. It has been branded in history's memory, and even a geologist mentioned it. He asked if Hallcienda had been under water in the flood of '38. I told him I thought that was pretty unlikely at an elevation of almost 3000 feet, but water had invaded halfway up the drive at the Devore home (Stony Acres) where Roger grew up. Floods, of course, like earthquakes, have been around long enough to have strong geological impacts on Earth's entire surface. Hallcienda is no exception. After the geologists visited following the Panorama Fire, we learned lots of interesting theories. One theory is that the ridge that separates us from the Christmas tree farm and helps to form Pitman Canyon broke off of Kimbark Canyon about a mile away and moved west. Another theory is that the gentle slopes comprising the living area of Hallcienda are an alluvial flow off the San Andreas Fault, which would certainly indicate a great deal of flowing water. And we saw that Christmas Day, 2003. Before then, the largest floods we remember were the

1980 Harrison Canyon flood that destroyed thirty-three homes in north San Bernardino, and the 1969 flood when the road connecting Hallcienda with Devore was washed out. It was a forestry road, and since they didn't show interest in repairing it, we didn't either. Hallcienda was left with just one entrance which also serves as the exit. Roger surmises that such an arrangement deters thieves. They wouldn't want to be caught leaving by someone coming! The 1969 flood yielded around 40 inches in two months and destroyed the trout farm in Cable Canyon. What we never understood was why a KOA campground was allowed to be placed in an area where another business had already been destroyed. One flood seeped into the front porch and destroyed a few years of tax records and other papers, but even when we measured 50 or 60 inches of rain a year, Hallcienda has not experienced much damage—except to the road. Roger has had to rebuild sections mostly because of interference from outside agencies which changed the contours of the land near the road when placing gas lines, cables, freeways, or fighting fires. Christmas of 2003 will live in memories forever. Almost seven inches of rain fell on fire-stripped hills, which dumped seven feet of soil, boulders, and debris on Greenwood Ave. in Devore and in Cable Canyon. Those mudflows destroyed homes, streets, yards, and lives when the KOA Campground washed away and killed Jan Bradley. If the trout couldn't survive 33 years before, why did the county allow people to move there? Unfortunately, the rains, desperately needed to break a five-year drought, didn't stop on Christmas, 2003. They were repeated in October 2004, when about 18 inches of rain fell with the same kind of damage on Greenwood Ave. plus a closing of the freeway I-215 due to debris from East Kimbark Canyon. The six inches of November snow were a welcome relief from all the drenching. But the floods occurred again in January, 2005, when another 20-26 inches fell in less than four days closing Foothill between Devore Road and Deercrest and the I-215 again. Addendum: Serious floods in Lytle and Cajon Creeks were also reported in January 1862

DEVORE RURAL PROTECTION ASSOCIATION



Community Updates

DEVORE COMMUNITY CHURCH

Community Church of Devore
 1431 Devore Road
 San Bernardino, CA 92407
 Contact: devoretruth@gmail.com
 (909) 880-4160
 Service Times
 Sunday: 10:30 AM
 Wednesday: 6:30 PM



DON'T FORGET

- Devore Water Company meeting at 7pm
- FREE EGGstravaganza event March 30 at DWC gates open at 12PM
- Everyone Saddle Up for St. Jude Ride donation event - Sheriff Rodeo Grounds- May 18th at 9AM
- DRPA meeting May 6 at 6:30
- Pancake breakfast Devore Fire Station 2 DRPA fundraiser June 9th at 10AM

NEED FOOD

Wednesday 4:30PM to 5:30PM
 Address: 1431 Devore rd.

EVERY WEDNESDAY THERE WILL BE A FOOD GIVE AWAY AT THE DEVORE COMMUNITY CHURCH

If you need food before or after Wednesday please call Roy at 909 495-5261

If unable to pick it up on Wednesday Moms Shop will be handing out food
 DEE DENTON - 909-289-6823

ALL DEVORE RESIDENTS ADVERTISE FOR FREE



2024 DEVORE T-SHIRTS

Prices:

S-XL = \$20
 2X-3X = \$25



T-shirt Decals



All decals (mountains or animal) available in Blue, Green, Grey

ADVERTISING PRICES

BUSINESS CARD SIZE... \$25
 1/4 PAGE... \$50
 1/2 PAGE... \$75
 FULL-PAGE... \$100

PRICING IS PER NEWSLETTER

SUBMIT AD PAYMENT TO : DRPA
 CASH/CARD/CHECK IS ACCEPTED

CONTACT: KARAN SLOBOM (909) 278-9896.

DEVORE RURAL PROTECTION ASSOCIATION

Advertisements



COLDWELL BANKER
HOME SOURCE
REALTY®
KARAN SLOBOM
DRE # 02060481
Call: (909) 278-9896
KaranS@cbhomesource.com

CB

Ph: 760-684-8100
12138 Industrial Blvd, Suite 102 • Victorville, CA 92206
www.CBhomesource.com

CABLE CANYON TRAIL RIDES

WE OFFER TRAIL RIDES, PONY RIDES, PHOTO SHOTS, BIRTHDAY PARTIES, AND RIDING LESSONS.

CONTACT BECKY
(951) 201-3928

MAKE APPOINTMENT TODAY!

Apologies to Russell Cammell and Advertisers for the typo error in the January newsletter

JUST LISTED

821 Woodlawn Ave. San Bernardino, CA

Features:

1. Split & Open Floor Plan
2. 1.5 AC of Usable Land
3. Family, Living & Laundry Room



3 2 1,499 sq ft

COLDWELL BANKER
HOME SOURCE



KARAN SLOBOM
DRE# 02060481
(909) 278-9896
KARANS@CBHOMESOURCE.COM



In Loving Memory of



LEZLIE JEAN (JODY) MARTIN

August 7th 1952

JANUARY 31ST-2024



Jody Martin, a Devore resident for over thirty years, will be remembered for her radiant smile, generous hospitality, and especially for her passion to share the love of Jesus with all. For many years, Jody's lovely voice and acoustic guitar blessed many at the Community Church of Devore (CCoD) where she led worship. She invigorated the CCoD youth group with her fun-loving personality. Jody's bright light in our community will be sorely missed. May we be comforted knowing that Jody is now joining Heaven's angels singing praises to her Savior.

"I press on toward the goal to win the prize for which God has called me heavenward in Christ Jesus."

Philippians 3:14 (NIV)



In Loving Memory of



**LAURA
"LOLLY"
COLUMBO**

FEBRUARY 28, 1960



JANUARY 11TH, 2024





DEVORE FOOD PANTRY

IF YOU ARE IN NEED OF FOOD

**WE ARE OPEN EACH WEDNESDAY
4:30 PM - 5:30 PM FOR FOOD DISTRIBUTION**

**LOCATION:DEVORE COMMUNITY CHURCH
1431 DEVORE RD**



KIMBARK CORNER

IT'S TIME TO REWIND TO THE 80'S
FAMILY SKATE NIGHT IS A PRIVATE EVENT FOR KIMBARK FAMILIES
THE PLAYLIST HAS BEEN MADE, SO GRAB THE AQUANET AND DRESS TO IMPRESS

FEBRUARY 12TH
NO SCHOOL

FEBRUARY 19TH
NO SCHOOL

FEBRUARY 22ND TO MARCH 1ST
EARLY DISMISSAL FOR
TEACHER CONFERENCES

FEBRUARY 22ND TO MARCH 1ST
BOOK FAIR

FEBRUARY 26TH
COFFEE WITH
THE PRINCIPAL @ 9AM

FEBRUARY 27TH
KINDER AWARDS &
PATRIOTIC ASSEMBLY

KINDNESS WEEK



MONDAY, FEBRUARY 12TH
FAMILY SKATE NIGHT @ CAL SKATE

TUESDAY, FEBRUARY 13TH
80'S HAIR DAY



WEDNESDAY, FEBRUARY 14TH
ROCK YOUR 80'S BAND SHIRTS

THURSDAY, FEBRUARY 15TH
NEON DAY



FRIDAY, FEBRUARY 16TH
FUNKY FRIDAY SOCKS AND LEG WARMERS



March Save The Dates



**PTO See's Candy
Fundraiser**



LEGO Night

March 12th
2nd & 3rd Grade
Bring a parent to PE

March 18th to March 29th
Spring Break